

Launch Contacts and from the menu select Contacts, Accounts

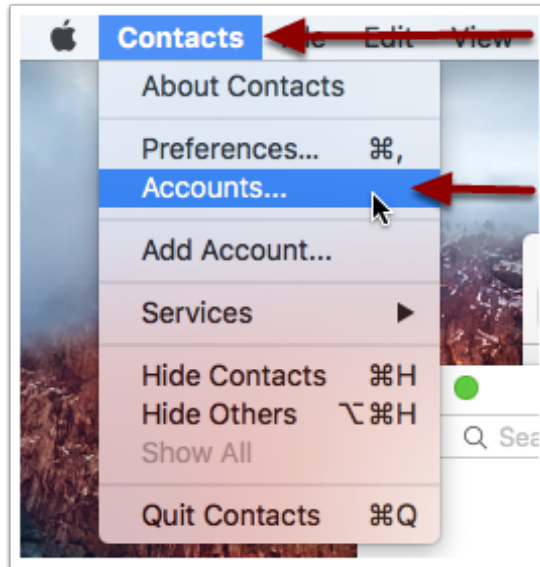

The following screen will appear. Scroll down and choose Add Other Account

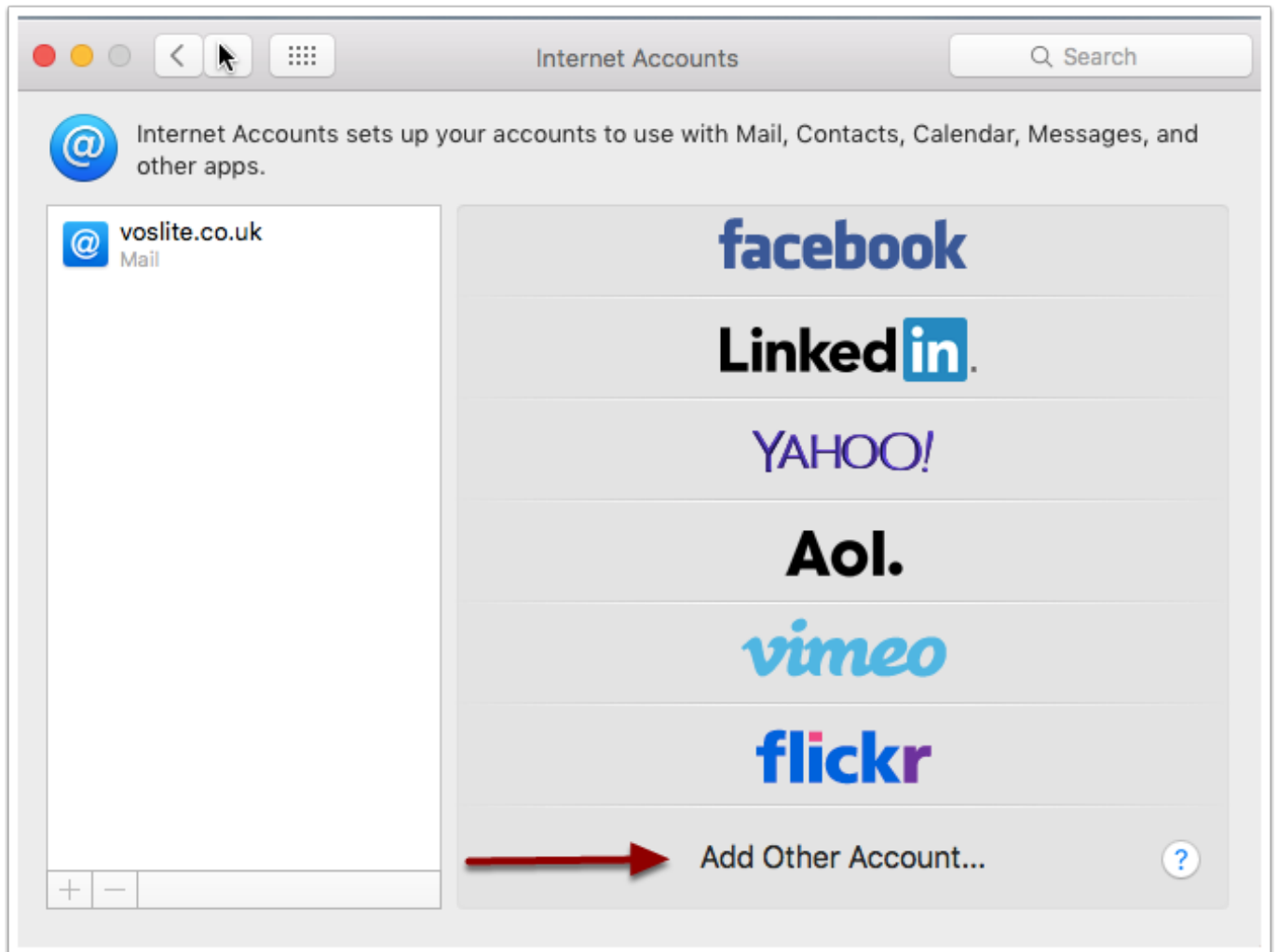

A 2nd screen will appear. Choose CardDAV account

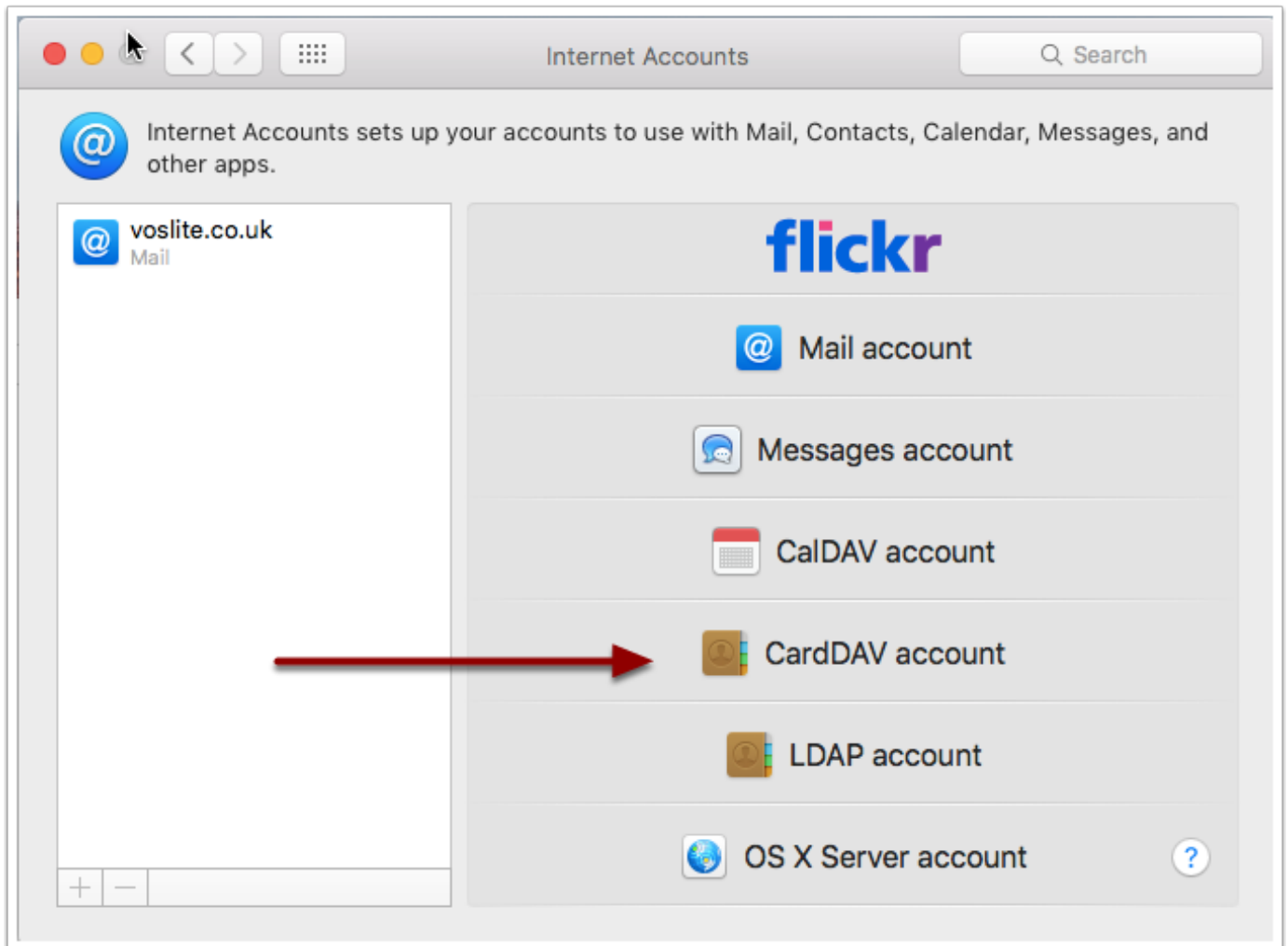

Under Account type choose Advanced. Your Username is your email address. Enter your password followed by the server address supplied by us. Leave Server Path empty and iuner port enter 443. Make surer SSL is ticket. Now click Sign in

The screenshot shows a dialog box titled "Add a Contacts account" with the following fields and controls:

- Account Type:** A dropdown menu set to "Advanced". A red arrow points to the dropdown.
- User Name:** A text input field containing "glenn@voslite.co.uk". A red arrow points to the field.
- Password:** A text input field containing ".....". A red arrow points to the field.
- Server Address:** A text input field containing "server49.vostel.co.uk". A red arrow points to the field.
- Server Path:** A text input field containing "/principals/user/".
- Port:** A text input field containing "443". A red arrow points to the field.
- Use SSL:** A checked checkbox. A red arrow points to the checkbox.
- Buttons:** "Cancel" and "Sign In" buttons. A red arrow points to the "Cancel" button.

The following screen appear to show it's enabled and can now be closed.

